

LAMP® FD30EX SLIDING DOOR SYSTEM Installation Manual

(Two-Way Soft Close, Recessed Mount Roller)

Part No.FD30EXDHCP

Thank you for selecting our product. Before starting installation, please read this manual thoroughly to ensure correct installation. Please keep this manual at hand for future reference.

ABOUT THE PRODUCT

- This product is a parts set for an indoor use sliding door system.
- The door closes in 2 soft motion steps; first slow, then fast, and opens with 1 step soft motion.
- Easy door installation and adjustment.

SPECIFICATIONS

Max. Door height	2400 mm
Max. Door width	590 – 1000 mm
Min. Door thickness	24 mm
Max. Door weight	30 kg ※ ¹
Height adjustment range	3mm upward, 4 mm downward
Forward / backward adjustment	±2 mm

- The closing speed of the soft closing type door may change due to ambient temperature, operating method or installation quality.
- Recommended ambient temperature range is 5 to 40°C.

※¹If a light weight door is applied, you may feel the resistance of the soft closer when opening the door.

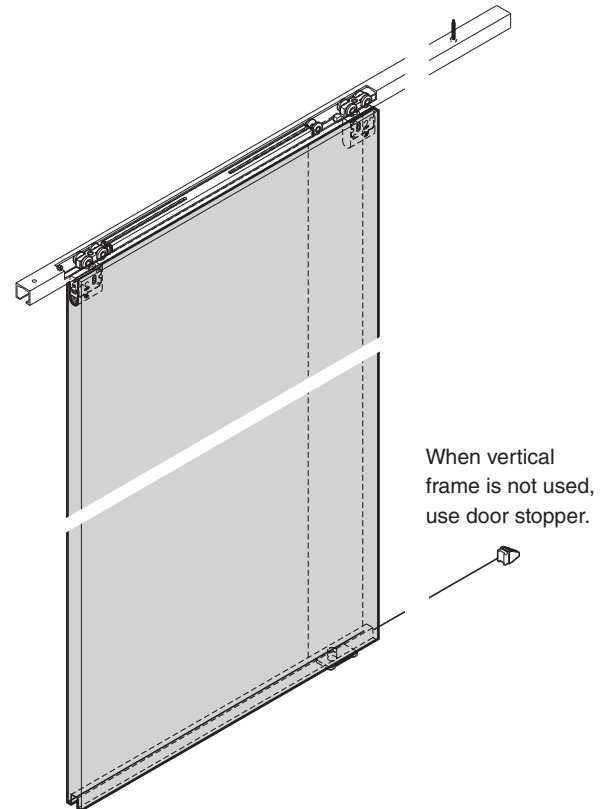

FOR YOUR SAFE WORK AND CORRECT INSTALLATION

Meaning of symbols

Warning Caution	Prohibited	Required
---------------------------	-------------------	-----------------

WARNING: If not followed, death or serious injury may result.

- ❗ This (sliding door system) should be installed by a qualified person. If the system is not installed correctly, the door will not operate smoothly, and may cause injury.
- ❗ It is necessary to manufacture the frame with sufficient strength so that it endures the weight of the door and any impact upon opening/closing the door. Only use designated screws and ensure that they are fastened firmly. A frame with poor strength or loose screws might result in the door falling and causing injury.
- ⊘ Do not try to use this product for anything other than its original purpose. Do not use any part for applications outside of its specification.
- ⊘ Do not disassemble nor modify any parts other than those described in this document.

Caution: If not followed injury or damage may result.

- ❗ Make sure to follow the designated dimensions, specifications, and horizontal/vertical angles. Make sure that the frame is not warped, since it may affect the movement of the door.
- ❗ If cutting any parts, make sure to remove any burrs before installation. Also check the upper track for any left-over burrs or scraps and remove these.
- ❗ This product is a part for architectural fittings. After installation, make sure to test the finished product thoroughly to ensure that it is well-functioning and safe. Please inform the end user about general precautions and safety to prevent improper use.
- ❗ Make sure to check the screws for slack at regular intervals (one month from first usage, half a year, and then one time every year is recommended).

COMPONENT PARTS

No	①	②	③	④	⑤	⑥	
Name	Recessed roller soft loser two-way soft close	Upper roller	Cover cap	Trigger	Floor guide	Upper track (surface mount)	Upper track (recessed mount)
Item No.	FD30EX-WRH-DSC	FD30-WRH-N	FD30-WRH	FD30-TRG FD30-TRJ	FD30-HBG	FD30-TRM	FD30-TRH
Item				 Trigger Jig			
	Accessory screw: Pan head tapping screw 3.5x30 3 pcs	Accessory screw: Pan head tapping screw 3.5x30 3 pcs			Accessory screw: Countersunk head tapping screw 3.5x30 4 pcs	(various sizes) Hole pitch : 300 mm Pitch end : 30 mm Recommended screw : Countersunk head tapping screw 3.5x20	
Single sliding		1 pc	1 pc	2 pcs	1 pc	1 pc	Use 1 (surface mounted or recessed)
Double sliding		2 pcs	2 pcs	4 pcs	2 pcs	2 pcs	Use 2 (surface mounted or recessed)
In line sliding		2 pcs	2 pcs	4 pcs	2 pcs	2 pcs	Use 2 (surface mounted or recessed)

No	⑦
Name	Stopper
Item No.	FD30-HSB
Item	
Single sliding	—
Double sliding	—
In line sliding	2 pcs

OPTIONAL PARTS	⑧	⑨	⑩	⑪	Accessory
	Door stopper (floor mount) FD30-HTKY	Recessed guide track under door FD30-HBRT	Bumper block FD30-HBB	Floor guide (long shaft) FD30-HBGH	
		1000 mm / 1500 mm Hole pitch : 300 mm Pitch end : 30 mm Recommended screw: Countersunk head tapping screw 4x20		 Accessory screw: Pan head tapping screw (Stainless steel) 3.5x30 4 pcs	
	Accessory screw: Bind head tapping screw 4x30 3 pcs				

INSTALLATION DRAWING (EXAMPLE)

Recommended screw : Philips flush tapping screw
Note : Not provided.

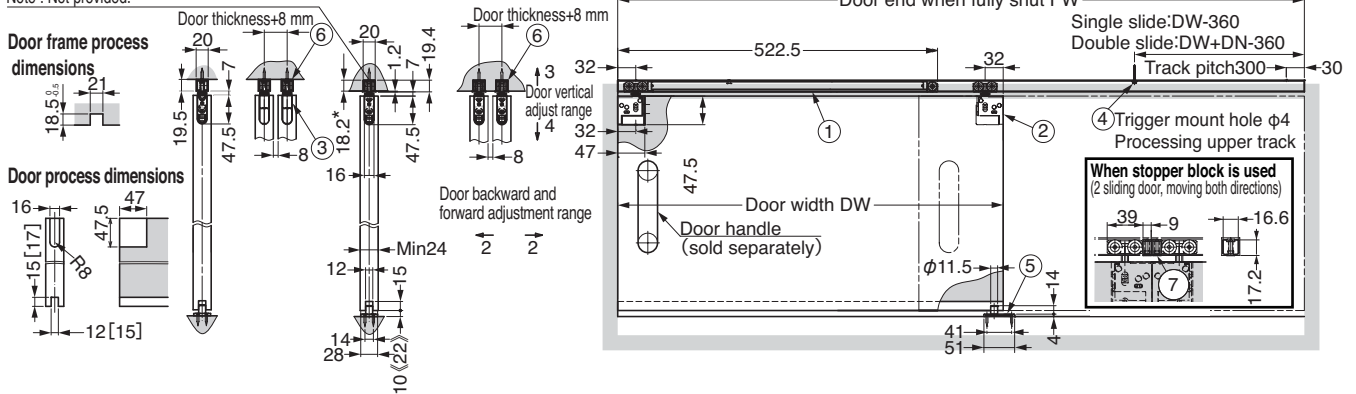

dimensions in [] : When recessed guide track (option) is used.
() : When long shaft floor guide (option) is used.

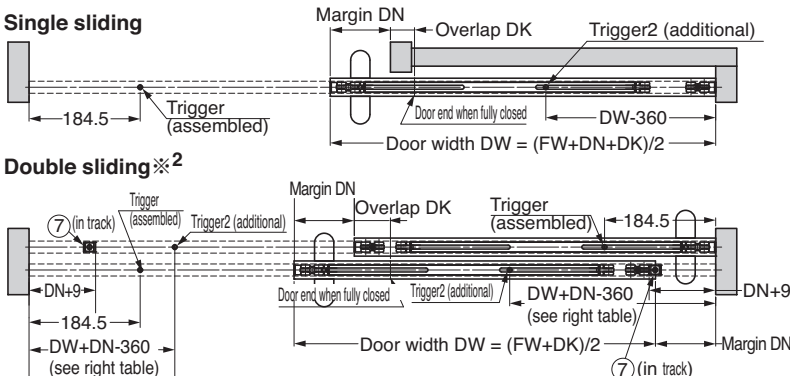

※² For Double sliding only.

INSTALLATION DIMENSIONS FOR TRIGGER 2

Please add the Margin DN to dimension for Trigger 2, if you are using a protruding handle.
Example shown below.

DW	[Margin DN = 0 mm] Installation dimension for Trigger 2	Example [Margin DN = 70 mm] DW+DN-360 is the Installation dimension for Trigger 2
600	240	310
700	340	410
800	440	510
900	540	610
1000	640	710

1 Cutting and Providing Hole on Upper Track

See "Supplement 3" for the position of trigger.

⚠ Caution

Do not cut trigger side (leading edge) of upper track.

⚠ Caution

When cutting, reinforce the track to prevent deformation at the cut section.

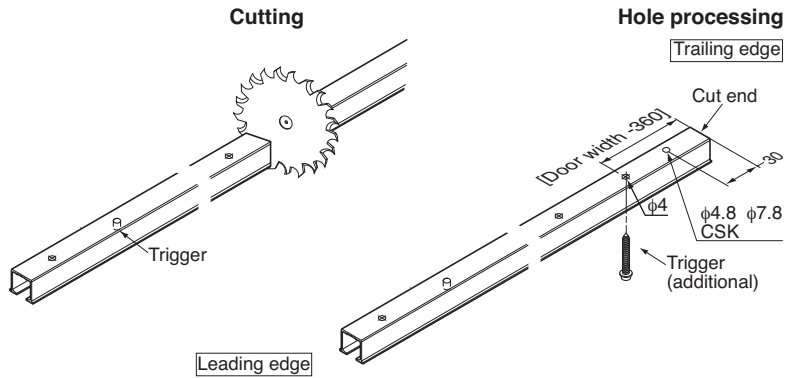

2 Preparation of mounting parts

Recessed roller: Separate main unit from casing.

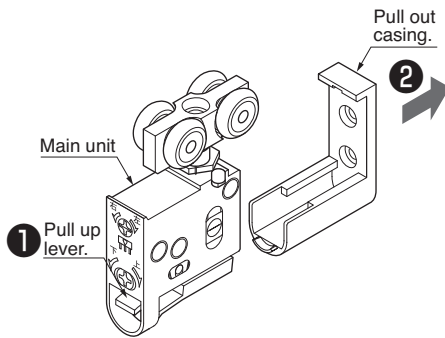

3 Installing Casing

Fasten the casing firmly with attached screws.

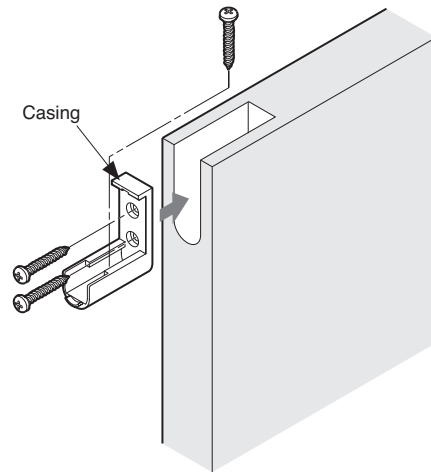

4 Verification Before Installing Two-way Soft Closer

If the position is wrong, pull back the trigger catcher to the correct position using a 6mm diameter round bar.

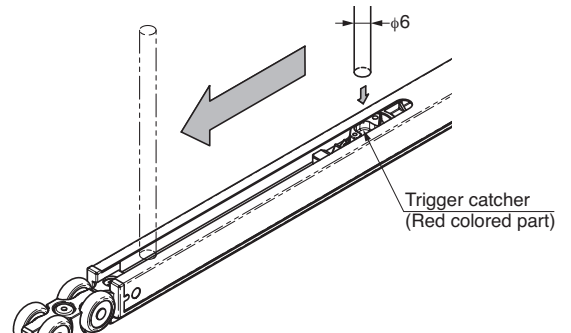
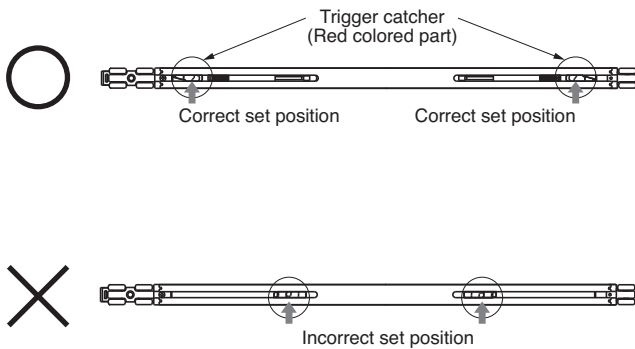

⚠ Caution

Without verification the self closing feature may fail.

5 Inserting Parts into Upper Track

Insert the parts in order from ① to ②.

Caution
Remove any dirt or aluminum chips from the track.

Caution
Tape recessed roller and upper track to prevent inserted parts from falling.

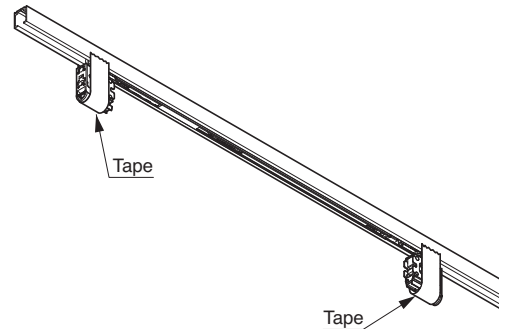
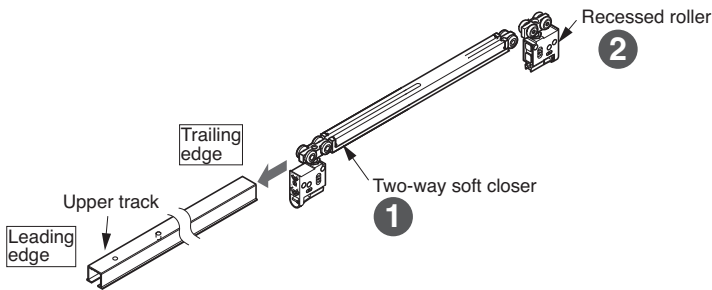

6 Fixing Upper Track

(Recommended screw: Countersunk head tapping screw 3.5x20)

Caution
Be careful not to overtighten the screws and screw heads protruding on upper track. It may cause deformation of track or damage of soft closer.

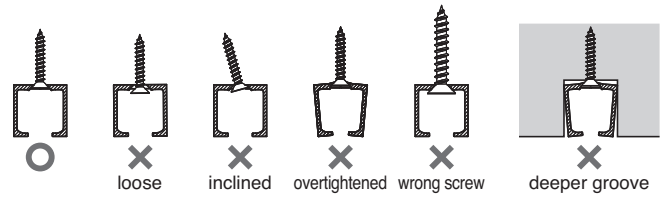
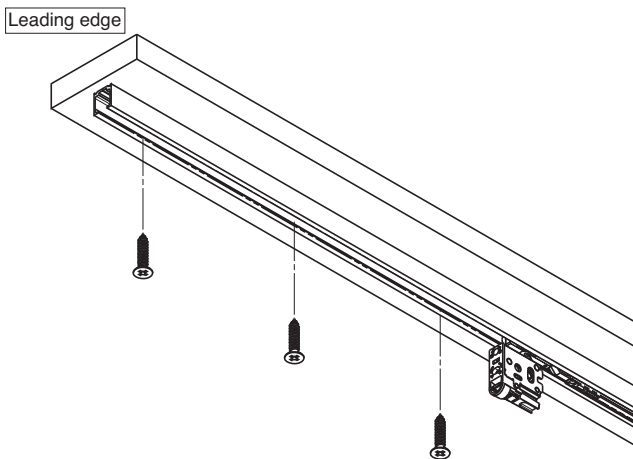

7 Fixing Additional Trigger

Fix trigger to the hole made during procedure ① with the jig.

According to the "Installation Drawing", install the additional trigger into the $\phi 4$ hole near the trailing edge using the provided trigger mount jig.

Caution Set the additional trigger vertically. Or, improper movement will result.

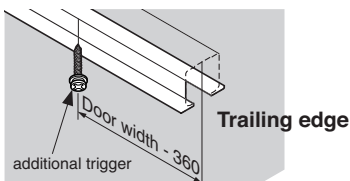

Operation of trigger mount jig

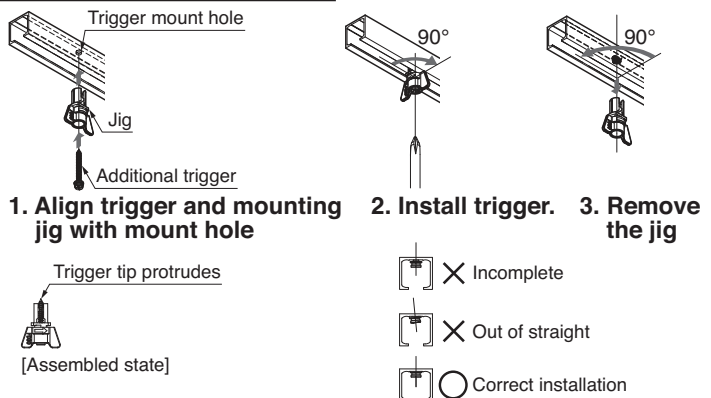

8 Fixing Floor Guide Temporarily

Position floor guide just below the center of upper track.

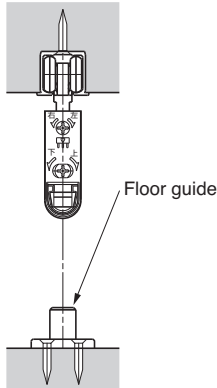

Position the floor guide so that its roller part stays under the door when it is opened or closed.

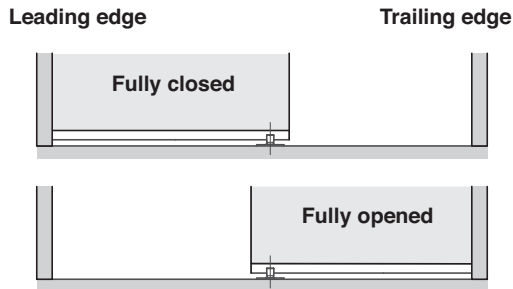

Fasten the four countersunk holes with provided screws.

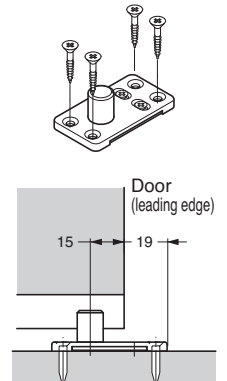

9 Hanging Door

Put a 10 mm support under the door. While holding the door, insert the floor guide into the groove under the door.

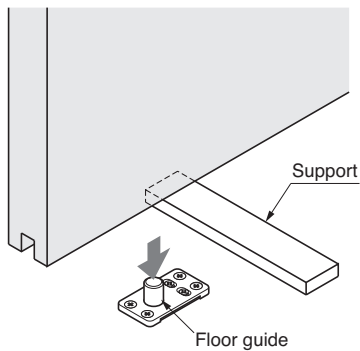

Insert the recessed roller into the casing until a "click" sound is heard.

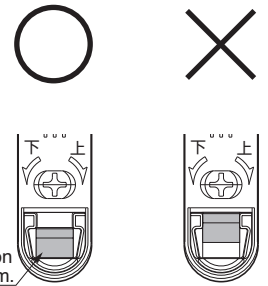
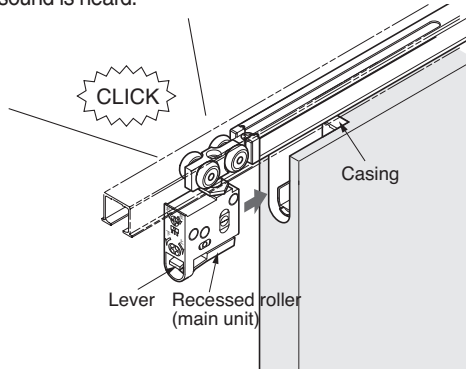

Caution

Confirm that the recessed roller is not dislocated from the casing, for both door sides.

10 Confirmation of Soft Closer Operation

Remove the 10 mm support from under the door. Close the door slowly and check that the soft closer works correctly.

The soft closer is engaged approximately 100 mm at leading edge (or 50 mm at trailing edge) before the door reaches its final position.

Please refer to the "Troubleshooting" section, when the soft closer does not work correctly.

Caution

Do not close the door with excessive force. It may cause damage to the soft close mechanism.

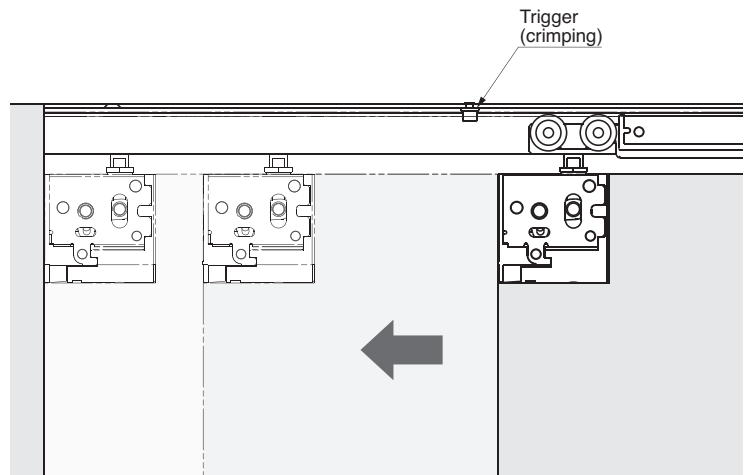

11 Adjusting Door Position

Adjust door parallel to upper track with 6-13 mm clearance between door and floor.

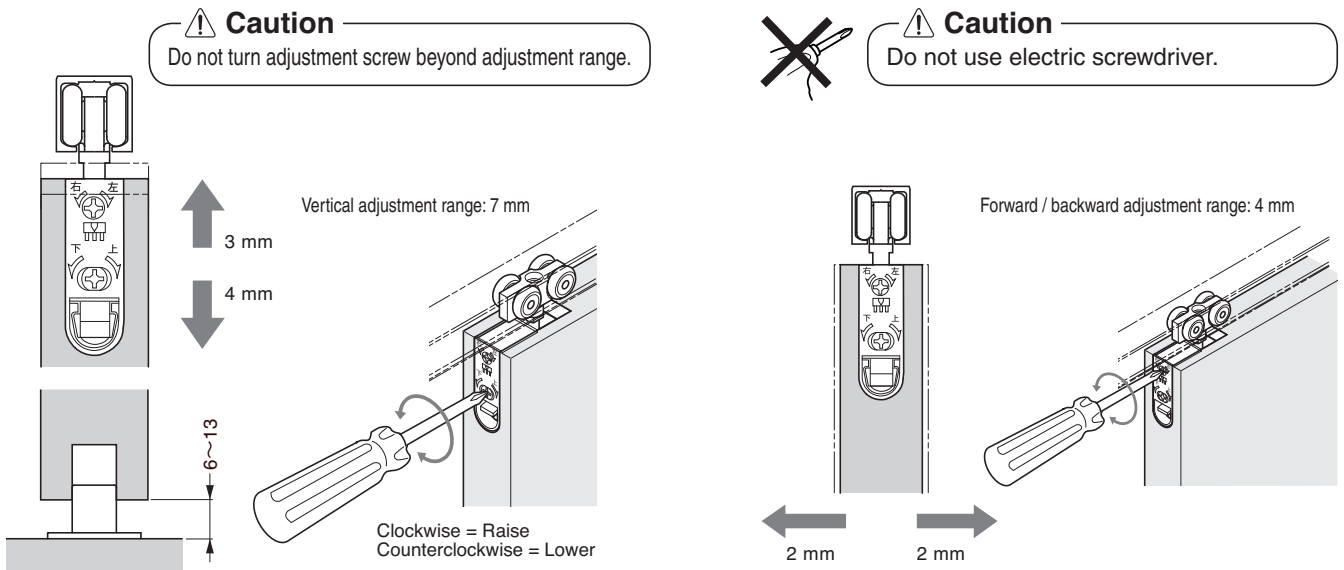

12 Adjusting the floor guide: adjustment range is 4 mm.

Slowly close and open the door.

If the door does not move smoothly, it is necessary to make a forward / backward adjustment for floor guide and door.

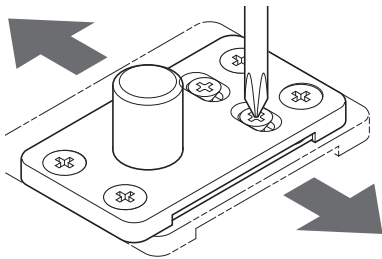

13 Fastening the Jump Prevention Nut

The jump prevention nut is on the hanger bolt of the recessed roller. Tighten the nut with the provided spanner until it contacts the soft closer.

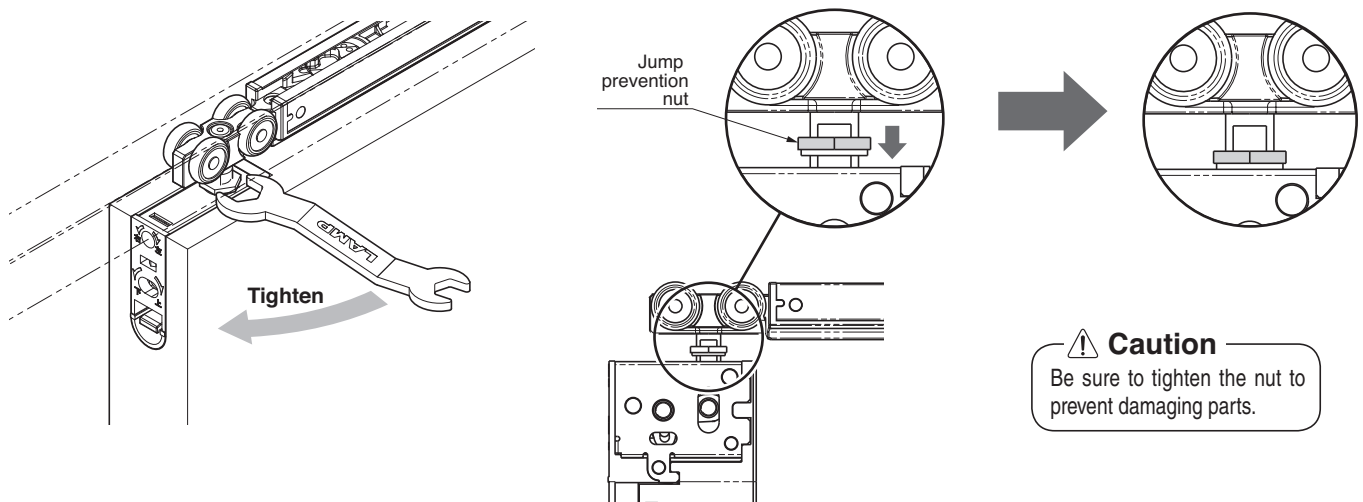

Supplement 1 How to remove door

Use a 10mm support under the door.
Then pull out the upper roller main unit from the door while raising the lever.

It will be easier if you slide the hanger bolt with a spanner.

Caution
Pay attention not to fall the door.

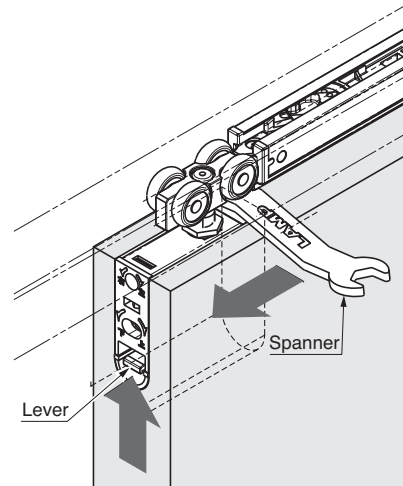

Supplement 2 When Vertical Frame is not Used

When vertical frame is not used, use the door stopper^⑧ and bumper block^⑩ on the track and on the floor.
Fix the door stopper.
Fix the bumper block to both the upper track ends, then adjust its positions where the door closes.

Caution
Recessed rollers may be damaged if door stopper and bumper block are not installed.

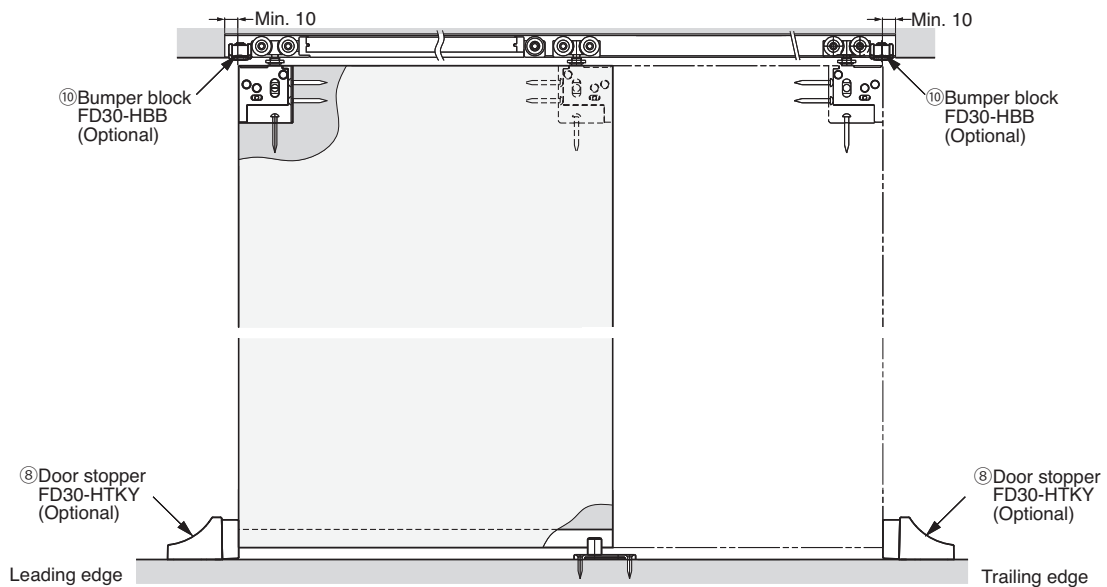

Supplement 3 Trigger positions

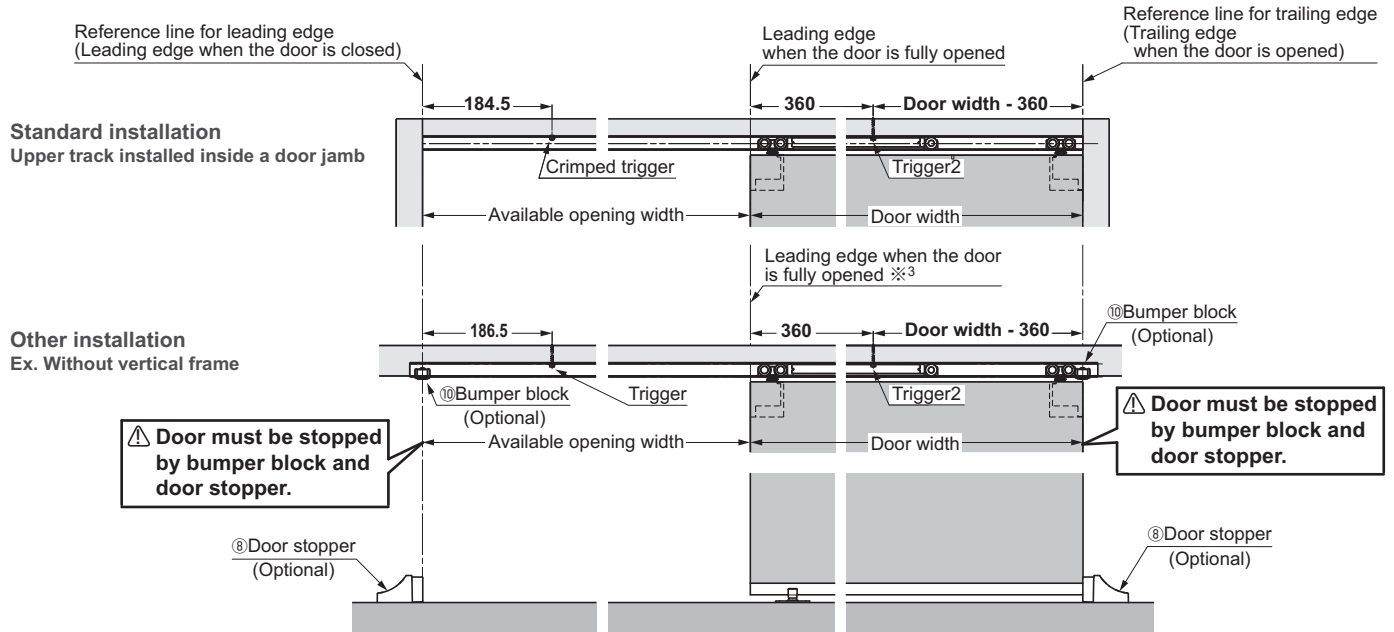

※³ Determine the trigger position from the leading edge of the door when it is fully opened. If a margin has been set, measure from the leading edge of the door when the door has reached the stopper ⑦.

Final verification Confirm that all screws are securely tightened. And, confirm that all screws have been used.

PERIODICAL INSPECTION

- Clean inside of track.
- Check the upper and lower gaps between the door and frame. If necessary adjust the gaps.

TROUBLESHOOTING

Trouble	Checkpoint	Solution
Door stops during soft closing.	Check if door bottom contacts with floor.	Confirm that track fixing screws are not loosened. Then, adjust door height such that the clearance between the door bottom and floor is 6 - 13 mm.
	Check if upper track is set horizontally.	Using a level gauge, reset upper track horizontally.
	Check if mohair seal is installed.	Reduce the friction between mohair and door.
No soft closing	Check if trigger is installed.	Install trigger to correct position.
	Check if door is closed by excessive force.	Do not close door by excessive force as it may damage soft closer.
	The position of the trigger catcher may become dislocated. (See section 4.)	Slowly move the door toward leading edge, then push the door firmly. Repeat this action on the opposite side as well. If it is still not improved, check the status of the trigger catcher in section 4.
Abnormal noise during operation	Check if door touches other parts.	Provide necessary space between door and adjacent objects.
	Check track rollers for aluminum dust.	Remove the track and pull out the roller. Then, clean the roller.
	Check for loose screws retaining the upper track.	Tighten the screw.
Heavy door operation	Check if door touches adjacent parts.	Correct door position to avoid contact with other objects. Adjust position of floor guide or stopper.
	Check if door is warped.	Replace door with one that is not warped.
Door does not move.	Check the track retaining screws for looseness.	Retighten screws to free the roller.

SUGATSUNE KOGYO CO.,LTD
Tokyo, JAPAN
Phone: +81 (0)3 3866 2260 E-mail:export@sugatsune.co.jp

SUGATSUNE KOGYO (UK) LTD
Reading, UK
Phone: +44 118 9272 955 E-mail:sales@sugatsune.co.uk

SUGATSUNE SHANGHAI Co., LTD
Shanghai, CHINA
Phone: +86 21 3632 1858 E-mail:lamp@sugatsune.com.cn

Guangzhou, CHINA
Phone: +86 20 6639 3552 E-mail:lamp@sugatsune.com.cn

SUGATSUNE AMERICA, INC
California, USA
Phone: +1 310 329 6373 E-mail:sales@sugatsune.com

Chicago, USA
Phone: +1 312 461 1081 E-mail:chicagoshowroom@sugatsune.com.

SUGATSUNE EUROPE GmbH
Düsseldorf, GERMANY
Phone: +49 211 53812900 E-mail:sales@sugatsune.eu

SUGATSUNE KOGYO INDIA PRIVATE LIMITED
Mumbai, INDIA
Phone: +91 22 28314490/91 E-mail:sales@sugatsune.in

ISO9001(Japan Offices and Sugatsune America) and ISO14001(Chiba Production division and Logistics center), certified.

SUGATSUNE CANADA, INC.
Phone: +1 514 312 5267 E-mail:support@sugatsune.ca

2018.10 1267-1