

**LAMP**

# AZ-GD180-HL STAINLESS STEEL SOFT CLOSING FLAP LID SYSTEM

## Installation instructions

Thank you for selecting our product. Before starting installation, please read this manual thoroughly to ensure correct installation. Please keep this manual at hand for future reference.

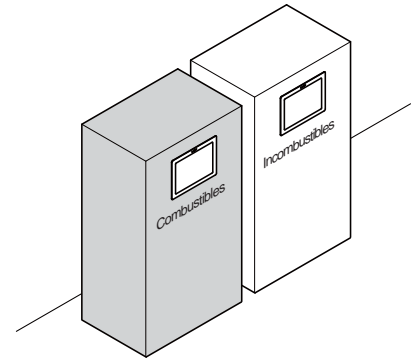

### ABOUT THE PRODUCT

- Damper allows silent closing of lid.
- Side plates for anti-pinch function.

### FOR YOUR SAFE WORK AND CORRECT INSTALLATION

#### Meaning of symbols

<b>Warning</b> Caution	<b>Prohibited</b>	<b>Required</b>
---------------------------	-------------------	-----------------

**Caution** If not followed injury or damage may result.

- ❗ The AZ-GD180-HL is designed to function when installed vertically as shown below. Horizontal, slanted or upside down installation will result in improper function and may lead to injury.
- ❗ To prevent the risk of the product falling and causing injury, ensure that the AZ-GD180-HL is securely fastened to a structure with adequate strength.
- ❗ Do not disassemble nor modify any parts other than those described in this document.
- ⚠ Recommended ambient temperature range is 0 to 40 degrees centigrade.
- ❗ The closing speed of the lid may vary according to ambient temperature. If the product is stored below zero degrees, please store in room temperature for several hours before use.

### PARTS DESCRIPTION

Description	Quantity
Flap lid body	1
Warning sticker	1
Cover cap	4

### TOOLS NEEDED FOR INSTALLATION

- Screws (not provided)  
Choose the suitable length according to the material to be mounted.  
Recommended screw : 3mm tapping screw . . . . . 4 pcs

### DIMENSION DRAWING

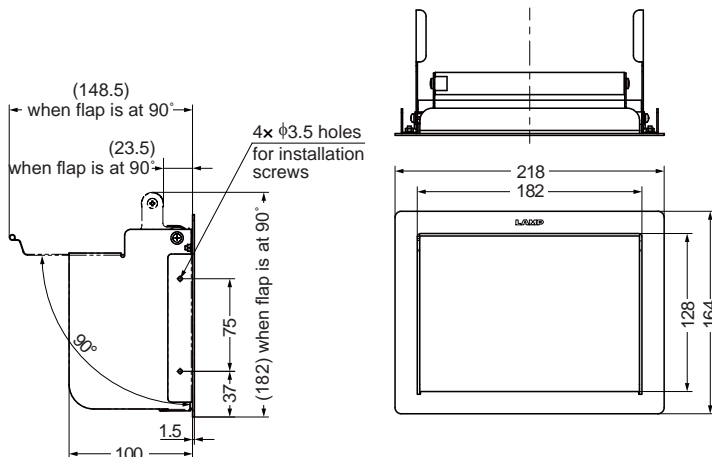

### CUTOUT DIMENSIONS

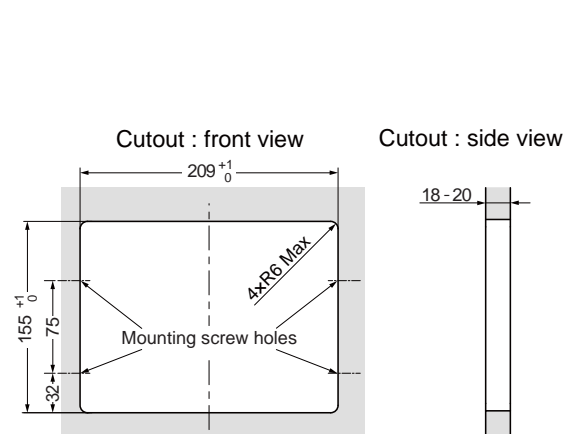

## INSTALLATION PROCEDURE

1

Make sure that the LAMP logo is at the top.

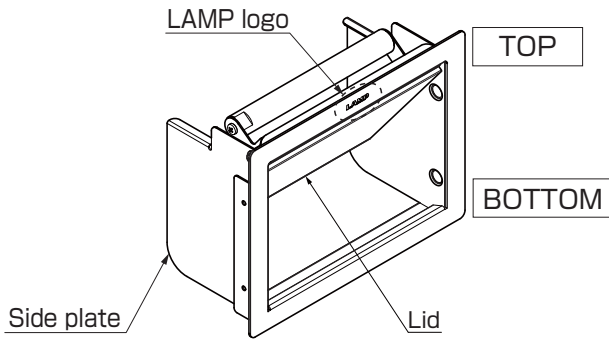

2

Do not leave any gap between the flap lid body and the mounting surface.

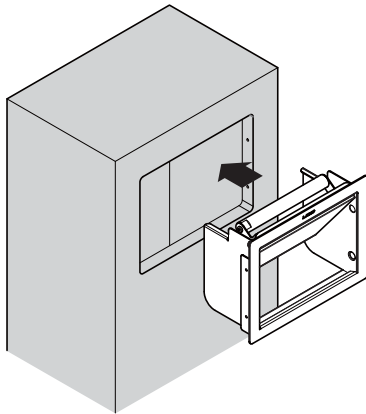

3

- [1] Having opened the lid, insert the screws through the provided access screw holes (two on each side) and fasten the flap lid body securely.
- [2] Make sure that the final assembly is securely fastened.

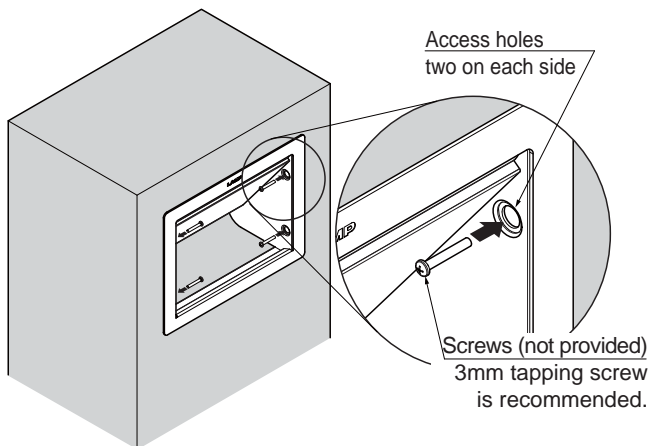

4

Slowly open and close the lid completely a few times in order to ensure correct operation.

5

Cover the access holes with the cover caps provided.

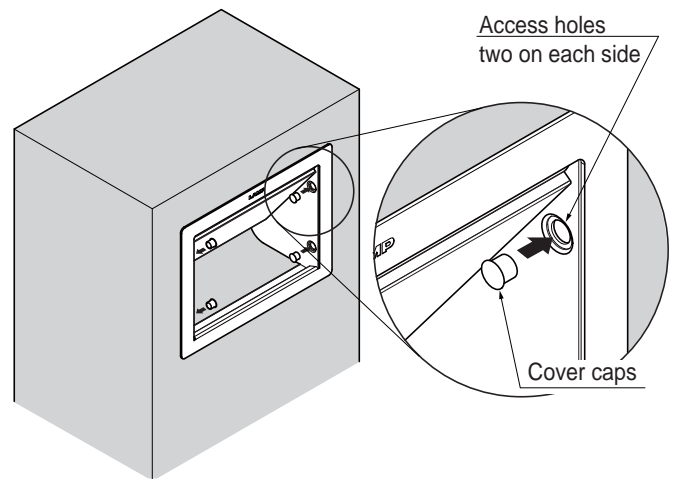

6

Paste the warning sticker in a visible position to avoid any injury when operating the lid.

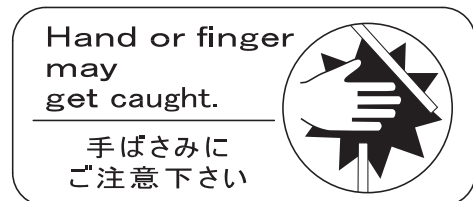

**SUGATSUNE KOGYO CO.,LTD**  
Tokyo, JAPAN  
Phone: +81 (0)3 3866 2260 E-mail:export@sugatsune.co.jp

**SUGATSUNE KOGYO (UK) LTD**  
Reading, UK  
Phone: +44 118 9272 955 E-mail:sales@sugatsune.co.uk

**SUGATSUNE EUROPE GmbH**  
Düsseldorf, GERMANY  
Phone: +49 211 53812900 E-mail:sales@sugatsune.eu  
ISO9001(Japan Offices and Sugatsune America) and ISO14001(Chiba Production division and Logistics center), certified.

**SUGATSUNE SHANGHAI Co., LTD**  
Shanghai, CHINA  
Phone: +86 21 3632 1858 E-mail:lamp@sugatsune.com.cn

**Guangzhou, CHINA**  
Phone: +86 20 6639 3552 E-mail:lamp@sugatsune.com.cn

**SUGATSUNE KOGYO INDIA PRIVATE LIMITED**  
Mumbai, INDIA  
Phone: +91 22 28314490/91 E-mail:sales@sugatsune.in

**SUGATSUNE AMERICA, INC**  
California, USA  
Phone: +1 310 329 6373 E-mail:sales@sugatsune.com

**Chicago, USA**  
Phone: +1 312 461 1081 E-mail:chicagoshowroom@sugatsune.com.

**SUGATSUNE CANADA, INC.**  
Phone: +1 514 312 5267 E-mail:support@sugatsune.ca